



STEP 1 *Determine if Cabinets are Face Frame or Frameless*

FACE FRAME

2. Confirm face frame material is solid wood (if not, using concealed hinges is not recommended)
3. Determine overlay (the most common size is 1/2"; door overlays on all sides by 1/2")
4. Measure according to overlay to determine finished door and drawer front sizes and hinge recommendations (see diagram on reverse side)
5. Visit hdsupplysolutions.com/fabrications to download or print the fabrications form, enter finished sizes, then email completed form to fmfabrications@hdsupply.com or fax to **1-866-455-8903** for quoting and ordering

FRAMELESS

2. Determine thickness of the cabinet's side walls; the most common thicknesses are 5/8" and 3/4"
3. If available, measure the existing doors and drawer fronts to determine the finished door sizes
4. Visit hdsupplysolutions.com/fabrications to download or print the fabrications form, enter finished sizes, then email completed form to fmfabrications@hdsupply.com or fax to **1-866-455-8903** for quoting and ordering

FACE FRAME CABINET

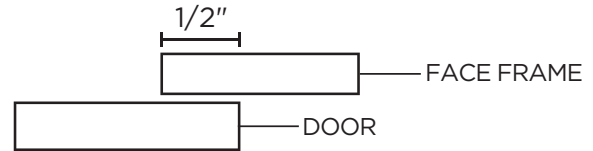
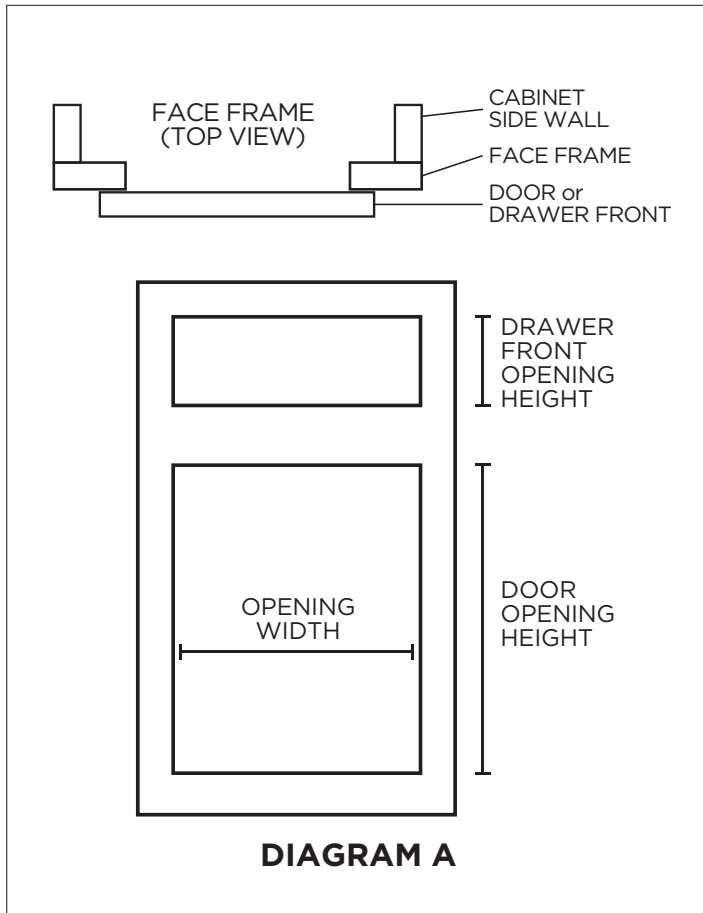

1/2" OVERLAY

Doors and Drawer Fronts Will Overlay Face Frame By 1/2" on All Sides

1. Measure the opening widths and heights (see diagram A)
2. Add 1" to the opening width and height to determine finished door size

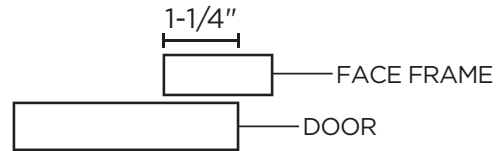

1-1/4" OVERLAY

Doors and Drawer Fronts Will Overlay Face Frame By 1-1/4" on Each Side and 1/2" on Top and Bottom

1. Measure the opening widths and heights (see diagram A)
2. Add 2-1/2" to the opening width and 1" to the opening height to determine finished door size

DOUBLE DOOR CABINET



USE THIS APPLICATION WHEN YOU HAVE ONE OPENING WITH TWO DOORS

- For 1/2" overlay, measure opening width, add 7/8", then divide by two
- For 1-1/4" overlay, measure opening width, add 2-3/8", then divide by two

FRAMELESS CABINET

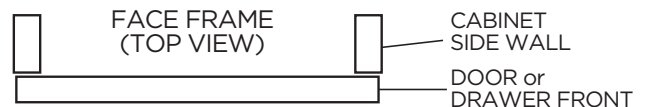

1. Measure existing doors and drawer fronts
2. Determine recommended hinge/plate combination by side wall thickness

CABINET DOOR OVERLAY

Definition of Overlay

Overlay is the measurement of overhang over the cabinet opening (per side, width, and height) that the finished size of the door or drawer front needs to have.

For example:

If a 1/2" overlay is determined, this indicates the finished dimension of the door and drawer front is 1" larger than the opening (width and height)

If a 5/8" overlay is determined, this indicates the finished dimension of the door and drawer front is 1-1/4" larger than the opening (width and height)

- Overlay becomes crucial when concealed hinges are used
- Overlay determines correct spacing and uniform layout of door and drawer front on the cabinet face
- Overlay also determines if a finger pull can or cannot be used (finger pull cannot be utilized for full overlay applications)

Example:	Width	Height
Cabinet opening	9-1/2"	21-1/2"
Finish size for 1/2" overlay	10-1/2"	22-1/2"
Finish size for 5/8" overlay	10-3/4"	22-3/4"

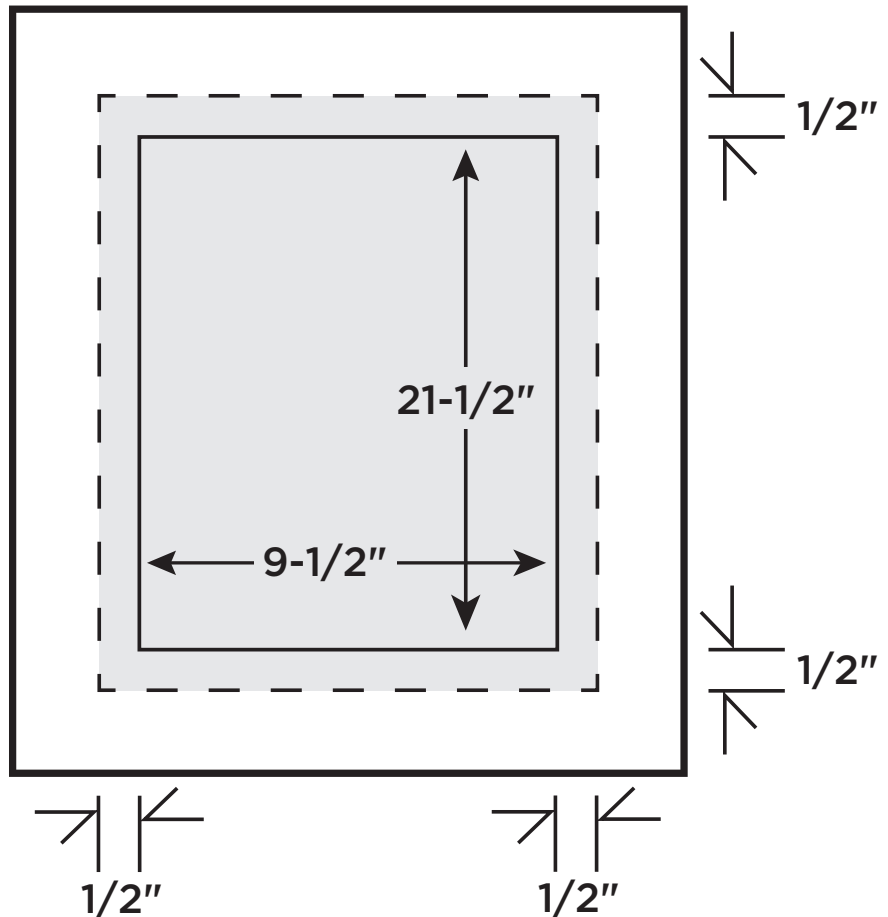

EXAMPLE OF 1/2" OVERLAY

- Dotted line depicts cabinet face
- Opening of face frame is 9-1/2" wide x 21-1/2" high
- Drawing shown depicts face frame application

READING A TAPE MEASURE

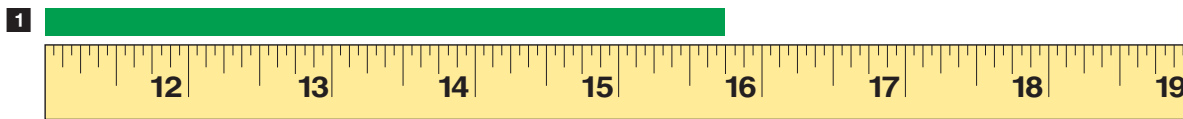

How Many Feet and Inches?

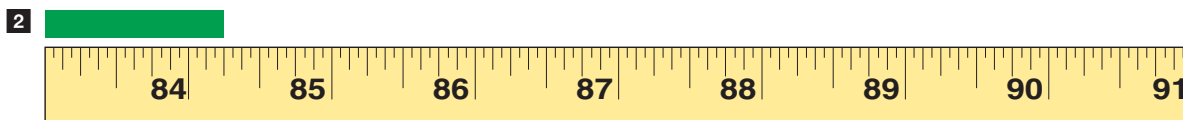

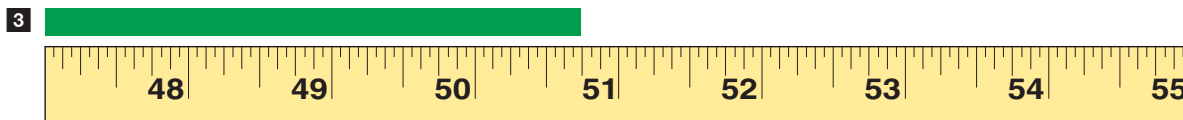

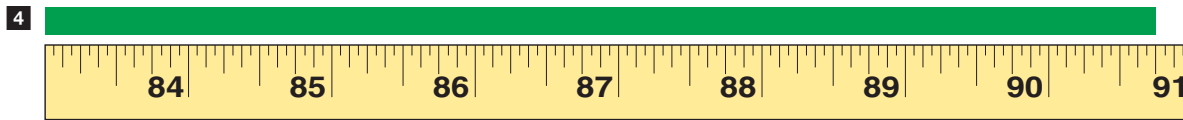

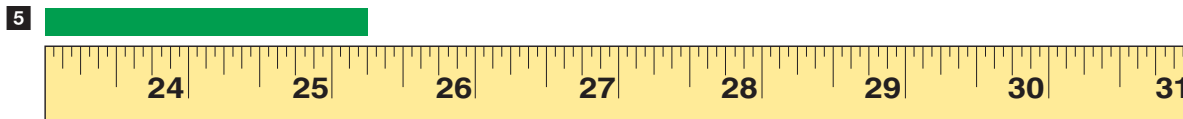

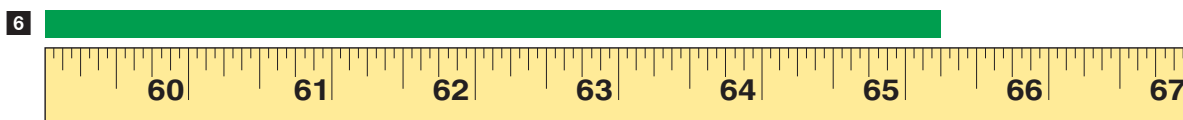

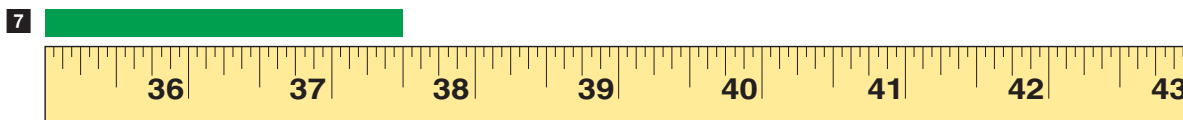

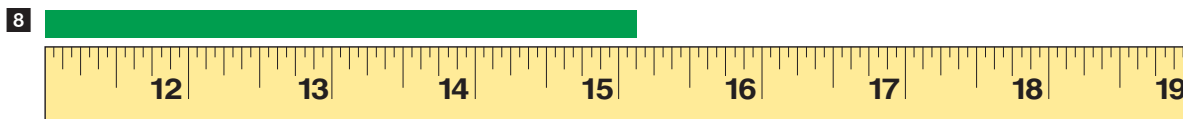

ANSWERS: 1. 1 Ft. - 3-3/4 In. 2. 7 Ft. - 1/4 In. 3. 4 Ft. - 2-3/4 In. 4. 7 Ft. - 6-3/4 In. 5. 2 Ft. - 1-1/4 In. 6. 5 Ft. - 5-1/4 In. 7. 3 Ft. - 1-1/2 In. 8. 1 Ft. - 3-1/8 In.