

Cutters

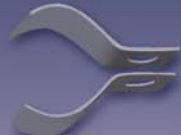

AH
Arrow Head Starting Drill
For 5/16", 3/8", and 1/2" cable.



1-1/4" SCB
1-1/4" Side Cutter Blades
For cutting and scraping.
For 5/16" and 3/8" cable.



1/4" and 5/16" Down Head
Lead cable down the stack – not up. For 1/4" and 5/16" cable.



1/4" and 5/16" Double Down Head
For especially difficult bends. For 1/4" and 5/16" cable.



1CG and 1-1/2CG Clog Chopper
Clears debris, scale, and crystallized urine. For 5/16" and 3/8" cable.



FAH
Flexible Arrow Head
For sharp turns in small lines. For 5/16" and 3/8" cable.



DHBG
Down Head Boring Gimlet
Goes down waste, not up the stack. For 5/16" and 3/8" cable.



BG
Boring Gimlet
For removing loose objects. For 5/16" and 3/8" cable.



DHF
Down Head Fitting
Can be used with all standard Handyletric cutters. For 5/16" and 3/8" cable.



LE-1 Small Flexible Leader
Attach to 1/2" wire rope center snakes to go through "P" traps and other close bends. For 3/8" and 1/2" cable.



RTR-1
Small Corkscrew Retrieving Tool
For removing loose objects. For 3/8" and 1/2" cable.



1-1/2" U-Cutter
For cutting and scraping. For 3/8" and 1/2" cable.



2CG and 2-1/2CG Clog Chopper
Clears debris, scale, and crystallized urine. For 1/2", 5/8" and 3/4" cables.



2" U-Cutter
For cutting and scraping. For 1/2", 5/8", and 3/4" cable.

SCB
Side Cutter Blades (Two Piece Set)
For cutting and scraping. Furnished in 2", 3", and 4" sizes. For 1/2", 5/8", and 3/4" cable.



RSB
Rotary Saw Blades (Two Piece Set)
For cutting and scraping. Furnished in 3" and 4" sizes. For 1/2", 5/8", and 3/4" cable.

For 5/8" and 3/4" Cable Machines



SHD
Spear Head Starting Drill



RTR-2
Corkscrew Retrieving Tool
For removing loose objects.



HDSC
Heavy Duty Side Cutters
In 3" and 4" sizes.



UC
2", 3", and 4" U-Cutters
For cutting and scraping.



SCB
Side Cutter Blades
For cutting and scraping. Furnished in 3" and 4" sizes.



RP-2
Root Ripper
Heavy spring screws into root mass, while front hook tears into stoppage. Passes through 4" "P" Traps.



RSB
Rotary Saw Blades
For roots and other stoppages. Furnished in 3" and 4" sizes.



3-6HDEC
Heavy Duty 3" to 6" Expansion Cutter
Can pass through 3" pipe to reach and clean 6" pipe. Can be put through 4" "P" traps.



4-6 SAC
Self Adjusting 4" to 6" Side Cutter Blades
Can pass through 4" pipe to reach and clean 6" pipe.



3CG and 4CG
Clog Chopper
Maneuverable cutter clears roots, debris, and scale. Available with connector to match General or other brands.

HDB
Heavy Duty Saw Blades
For roots and other stoppages. Furnished in 3", 4", and 6" sizes.



LE-2 – Large Flexible Leader
Used with both 3/4" or 5/8" wire rope center cables to go through "P" traps and other tight bends.



LE-3 – Large Flexible Leader
Used with both 3/4" or 5/8" wire rope center cables to go through "P" traps and other tight bends.

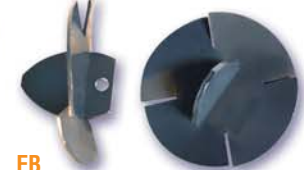

FB
Five Blade Fan Type Digger
For digging and removing silt, sand, etc.



Cutter Set for 7.5R7, 7.5R8 – 5/8" Sectional Cables



R-AH
Arrow Head



R-BG
Boring Gimlet
For removing loose objects.



R-1-1/2 UC
1-1/2" U-Cutter
For cutting and scraping.



R-RTR-1
Corkscrew Retrieving Tool.
For removing loose objects.

Cutter Set for 15R10 – 7/8" Cables



R-HA-10
Hook Auger For breaking up stoppage and retrieving.



R-SHD-10
Spear Head



R-2UC-10
2" U-Cutter
For cutting and scraping.



R-3UC-10
3" U-Cutter
For cutting and scraping.



R-RTR-10
Corkscrew Retrieving Tool
For removing loose objects.

Rodrunner/Model 88/Hot-Rodder Standard Cutter Set

(Note all cutters illustrated with "G" connector. If ordering with "L" connector, drop "G" prefix and substitute "L". For example: L-SHD.



G-SHD
Spear Head



G-2UC
2" U-Cutter



G-3HDSC
3" Heavy Duty
Side Cutter



G-4RSB
4" Rotary
Saw Blade



G-3HDB
3" Heavy
Duty Saw Blade



G-RTR2
Retrieving Tool



CW
Coupling Wrench
(Fits both "G" and "L" connectors.)



G-HA
Hook Auger

Rodrunner/Model 88/Hot-Rodder Standard Cutter Set



G-SC
Spade Cutter
Wide blade with sharp edge.



G-CA
Cutter Adapter
Converts all cutters on page 34-35
for use with "G" connectors.



G-BA
Bulb Auger
Coiled from heavy gauge oil-tempered
wire for use in 4" plastic pipe.

WCC
Wheeled
Cable
Carrier



Holds five
10-ft. sections.



G-FSH
Flex-Spear
Good in 4" "P" traps.



G-CL
Cutter Leader Adds flexibility to front of Proflex cables.



CF
Cable Feeding Tool
(Standard with Model 88)
Helps work cable around
tight bends.



CC
Cable Carrier
Holds five 10-ft. sections.

Accessories



Snake Oil™

Protects your cables better than common lubricants. Its special rust inhibitor cuts through moisture and replaces it with a rust-resistant coating. In addition, Snake-Oil gives your equipment a fresh, clean smell.



Catalog Number

Description

SOQ	1 Quart Snake-Oil
SOQ-12	12 Quarts Snake-Oil
SOG	1 Gallon Snake-Oil
SOG-4	4 Gallons Snake-Oil



MGT Manhole Guide Tube

Supports drain cables in manholes. Adjusts from 6'2" to 9'4". 4'4" extensions available.



SG Cable Starter Guide

Guides cable away from trap. Position in pipe by hooking wire into hole in Guide.

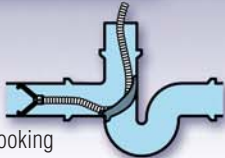

SIG Splash/Impact Goggles

Can be worn over glasses.



QF "Quick Fix" Repair Coupler

Just screw on tightly and it won't come off. For 1/2", 5/8", and 3/4" sizes.



FC Butt-Weld Connector

Passes through automatic feeds. No need to adjust feed. For 5/8", and 3/4" sizes.



FC-O Cup Type Connector

Sheath fits over cable for easier repairs. For 5/16", 3/8", 1/2", 5/8" and 3/4" sizes.



RS Repair Sleeve

In 3/8", 1/2", 5/8", and 3/4" sizes.



GT Cable Guide Tube

Adds safety when you can't get machine close to drain opening. 5 ft. extension attaches to cable guide tube.



GTE Guide Tube Extension

30" long and 1" in diameter. Easily attaches to 5 ft. extensions, made of rigid conduit with flexible end.

Cables

Flexicore® Cable



Wire Rope Center Construction

Heavy-gauge wire coiled tightly around 49-strand aircraft-type wire rope and heat treated. Has unequalled strength and the right amount of flexibility. So tough it carries a one-year warranty against defect or breakage.

Flexicore Patent Nos. 2,244,735 and 2,849,870



General Flexicore® Cable with Male and Female Connector



"SP" Connector

SP cables are available in 5/8" and 3/4" diameter.

Sectional Cables

Sections for Model 88, Hot-Rodder and Rodrunner come in the all purpose Flexichain which has a chain center, a stiffer Proflex which has a spring center, and a hollow style. Proflex is also available with a heavier duty 5/8" spring center.

Choose from three coupling styles. They snap together in a second and are taken apart quickly with a spanner wrench or uncoupling key. With the more recently developed "G" connector, no torque is put on the locking pin when running in reverse, making it a durable coupling.



Flexichain® Section



Proflex® Cable



"G" Connector Pat. No. 3094011



"L" Connector



15R10-P Proflex® Cable