



Fluidmaster®

PerformMAX™

**High Performance
Toilet Fill Valve**

**Quietest and
most powerful
fill valve on
the market**

Works with all toilets,
including Kohler®, Toto® and
American Standard®

Universal fit, perfect for:

- High efficiency toilets
(HET 1.28 gal.)
- Dual Flush including
DUO FLUSH™
- 1.6 gallon toilets with
2" and 3" flush valves
(1994 & newer)
- Older high gallon toilets
with 2" Flush valve
(1994 & older)

**Maximize toilet
performance
and save water**

**7 YEAR
WARRANTY**

**Preferred by
Toilet Manufacturers**

Fluidmaster®



Large Turbo Port:
For exceptional fill power.

Water Saving Roller Clamp:
Lets you regulate fill level in the bowl, saving water and money.

EZ-Twist Height:
Adjusts from 10" to 15" to fit most tanks.

Double Flange Design:
For ultra quiet fill.

Torque Guard Lock Nut:
Prevents thread damage from over-tightening.

400ARHR

PerformMAX™ High Performance Toilet fill Valve

Universal Fit

**2X greater refill rate
than standard fill valves**

**Avoids excessive or
inadequate bowl
fill levels**

Quick, Easy Installation

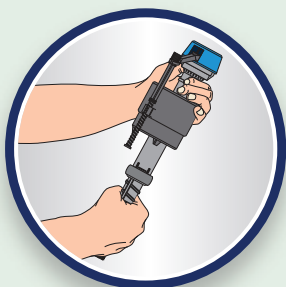

Set Height.



Install.

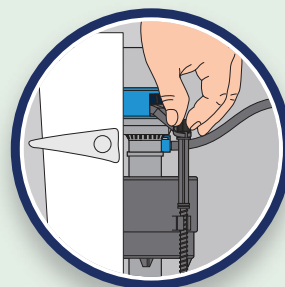

Adjust.

MODEL NUMBER	CASE QTY	PRODUCT DIMENSIONS H/W/D (INCHES)	CASE DIMENSIONS H/W/D (INCHES)	CASE WEIGHT (LBS)	UPC 0 39961	SCCI 2 OF 5 100 39961
400ARHR	10	12.5 x 4.5 x 3.125	12.625 x 8.625 x 16.5	8.0	70245 6	70245 3

Fluidmaster, Inc. at 30800 Rancho Viejo Road, San Juan Capistrano, CA 92675
(949) 728-2000, Fax (949) 728-2205.

Red/Green color arrangement is a registered trademark of Fluidmaster, Inc.

© 2011 Fluidmaster, Inc. ® Registered trademark of Fluidmaster, Inc.

U.S. and Other Patents Pending.

10/11 FM91399 Rev.2

**The latest
technology & best
performance**