

Key	Part Number	Description
1	202-2000	Base Assembly
2	150-1000-4	Mast Assembly
3	160-1000A	Standard Seat Assembly, w/o Footrest
4	220-3100	Concrete Blocks
5	202-6000	Housing Assembly
6	200-7000	Handle Assembly
7	400-7000	Controller Assembly, Not Keyed, 4-button
	400-7000K	Controller Assembly, Keyed, 4-button
8	160-1700A	Footrest with Hardware
9	1001495	LiftOperator Battery
10	800-1199	1/2" Flat Washer
11	800-2003	1/2"-13 Lock Nut 18-8
12	200-2222	Front Caster (Rigid) Assy. with Hardware)
13	200-3333	Rear Caster (Swivel) Assy. with Hardware
	1001600	Hand Control, 4-button (not shown)
	1001530	Battery Charger, LiftOperator (not shown)
	900-1000	Seat Belt Assembly (not shown)
	120-20005	Cord Routing Kit, 47 inch (not shown)

PAL, PAL2, and Splash! Motor Assembly

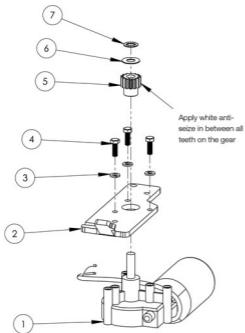

Key	Part Number	Description
	120-1000	Motor Assembly, Complete (includes items 1 - 7)
1	120-1100	24V Motor Assembly
2	120-1200	Motor Plate
3	5-149	1/4" Lock Washer S/S
4	800-2025	6mm x 1 x 20mm Long Cap Screw
5	800-5065	Small Spur Gear, Plated
6	05-32-111	3/8" Nylon Washer
7	800-2064	10mm Push Retainer