

QuickFitting® SurePress® is line of press fittings that visually confirms a pressed connection. Green indication will fill windows once pressed, confirming a successful seal. Allows installers and inspectors to quickly identify if a fitting has been pressed prior to pressure testing.

Features and Benefits

- SurePress® Technology: PRESS-GREEN-GO
- Green indication in windows confirms a pressed connection
- Visible indication up to 5 ft. away
- Quickly identify if fittings are pressed prior to pressure testing
- Lead free materials - safe for potable water
- No heat, flame or Hot Work Permit needed to install
- Compatible with all leading brand hydraulic press tools and jaws
- Limited Lifetime Warranty

Materials

- Body Construction: Brass
- Sealing Element (O-ring): EPDM

Performance

- Operating Pressure (Max): 250 psi
- Test/Burst Pressure (Max): 600 psi
- Operating Temperature: 0°F - 200°F

Pipe Compatibility

- ASTM B88 compliant Type K, L, M copper tubing
 - Hard copper: Nominal sizes 1/2" to 2"
 - Soft copper: Nominal sizes 1/2" to 1-1/4"

Approved Applications (Services)

Approved for above and below ground applications but requires approval from local inspector prior to installation due to codes and soil conditions.

- Fluids/Water
 - Hot and cold potable water
 - Rainwater/Gray water
 - Chilled water
 - Residential steam (5 psi maximum)

Listings & Certificates

- IAPMO/ANSI Z1117
- IAPMO/ANSI Z1157
- NSF/ANSI 61
- NSF/ANSI 372
- IAPMO Listed

Compliant with:

- ASTM B88
- ASTM D2000

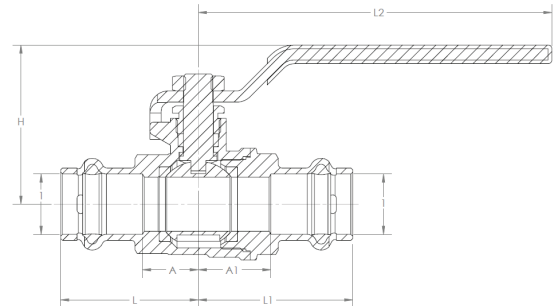

Dimensional Data

Size (P x P)								
Part No.	1	1	H	A	A1	L	L1	L2
SPBV11R	1/2	1/2	1.68	0.59	0.77	1.46	1.63	3.74
SPBV22R	3/4	3/4	1.90	0.73	0.91	1.63	1.81	3.74
SPBV33R	1	1	2.27	0.87	1.02	1.97	2.13	4.29
SPBV44R	1-1/4	1-1/4	2.85	1.03	1.20	2.39	2.56	5.67
SPBV55R	1-1/2	1-1/2	3.26	1.23	1.37	2.77	2.90	5.69
SPBV66R	2	2	3.53	1.77	1.64	3.30	3.45	6.42

Fitting Size	Pipe Insertion Depth
1/2"	3/4"
3/4"	1"
1"	1"
1-1/4"	1-1/16"
1-1/2"	1-3/8"
2"	1-1/2"

Item # Submitted	
Job Name	
Date	
Engineer	
Contractor	
PO #	
Tag	